

**maeg**

- BUILDINGS AND SPECIAL STRUCTURES

# **ADD Airport cargo terminals**

Airports

# ADD AIRPORT CARGO TERMINALS

## Location

Addis Ababa, Ethiopia

## Client

Ethiopian Airlines

## Contractor

Safet S.p.A.

## Scope of work

Design, fabrication and installation of steel structures

## Period of execution

2014-2015

## Weight

1.680 tons

To spur export and consequently the development of the country, the national air company Ethiopian Airlines is investing on new areas to host and transfer agricultural products destined to foreign countries, quadrupling the storing surface at the main airport of Addis Ababa.

The enlargement of the main cargo terminals of the ADD airport of Addis Ababa has been inaugurated on the 29th of June 2017, increasing the hosting capacity to 1.5 million tons of goods per year, making of it one of the biggest cargo terminals in the world and the largest one in Africa. Altogether, the area covers a surface of 150.000 square meters. This economic effort aims to incentivize export and support the growth of local economies. Maeg has contributed by supplying and installing the

supporting structure of these buildings, with a total weight of 1.680 tons.

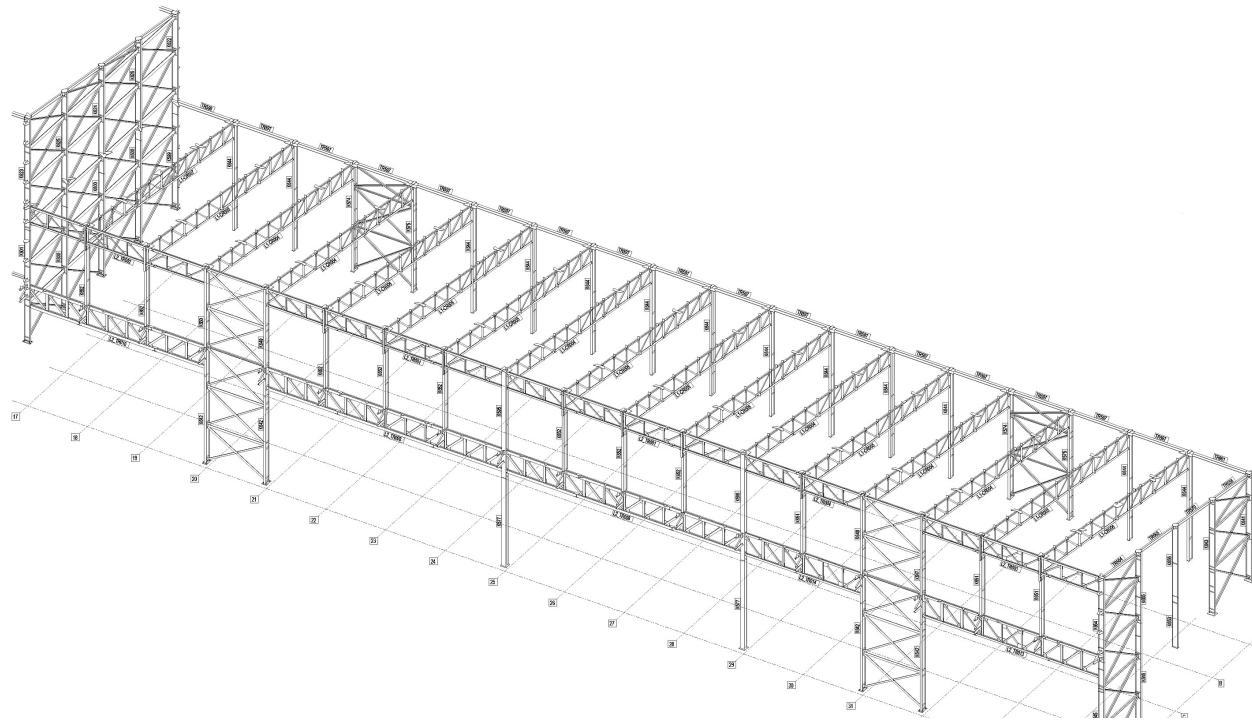















Ideas  
**shape**  
the  
World

Maeg Costruzioni S.p.A.  
Via Toniolo 40  
31028, Vazzola (TV) - Italy  
+39 0438 441558  
[www.maegspa.com](http://www.maegspa.com)